



Ph : 0 7 4 0 9 5 4 2 9 6

[www.tolgatraders.com.au](http://www.tolgatraders.com.au)

## July 2011 Model Safari SV from \$22,840.00

### **Trailer Specifications as of the 1st July 2011**

- 7' x 4' Trailer with double pressed Zincaneal panels for added strength
- Powder coated finish on trailer tub for strength and durability (big choice in colours)
- 520mm high sides with heavy duty greasable pin hinges on tailgate
- Fully Hot Dip Galvanized Heavy duty Chassis with 2000 mm long 100 x 50 x 3 mm Drawbar
- AL-KO Outback 8 Leaf heavy duty shackle springs with greasable pins rated to 1720 kg
- 10" Solid 1000 kg rated heavy duty swing up jockey wheel "U-bolted to drawbar"
- Oz Hitch off road coupling 3.5 tonne rating and recessed into drawbar for better line up with most 4wd's
- Drop down stabilizer legs
- Alloy mudguard and side trims to prevent stone chips
- Spare wheel mounted on tailgate or drawbar with spare wheel cover
- Mudflaps

### **Trailer Features**

- 3 x new 15" rims in white, silver or black with new 31x10.5 R15 All Terrain tyres (upgrades available)
- 2 x 4.5 kg gas bottle holders with quick release catches
- 3 x Jerry can holders
- 2 x recovery lugs on rear
- Heavy duty hand brake
- 12 Volt power set up with 50 Amp Anderson plug, 2 x Battery box and 3 x 12 volt outlets (2 x LH rear & 1 x fridge outlet)
- 2 x 105 Amp hour AGM Batteries
- Quality LED taillights and number plate light
- Gas strut on tailgate to stop kitchen from moving
- 2 x Toolboxes above mudguards with lockable T-locks
- 1425l x 440h x 500w top quality alloy toolbox with 2 x Lockable T-Locks (larger sizes available)
- Tilting bed base on gas struts
- 85 litre water tank with 1 x hand pump tap outside & 1 x tap in kitchen with 12 volt pump
- Steel pole carrier 200mm x 200mm x 1710mm long with side door for easy access
- 10" AL-KO Off road electric brakes (excludes brake controller)
- Slide out kitchen with 3 burner stove, stainless steel sink with glass lid and 12 volt water pump, quick connect gas fittings, complimented with a built in fridge box and a 60 litre Evacool fridge/freezer
- Slide out storage box with 2 x draws built in (other systems available on request) for easy access and organised storage
- Heavy duty stone guard with Trackabout mudflaps to help prevent stone chips
- Alloy ladder for easy access to bed

## Tent Specifications

- Australian Wax Converters Dynaproofed canvas
- All tents manufactured by Trackabout (no imported tents)
- 12oz walls & 15oz roof (see diagram for standard tent sizes)
- 6 large full length windows
- 8' zip on awning with gable front and spreader bar kit for a quick easy set up
- 2 x wall vents to maximise airflow
- Zip access for toolbox above mudguard
- Meshed door with excellent water proof coverage around zips
- Comes standard with kitchen wall
- Quality queen size high density foam mattress
- All pegs, poles and ropes
- Tonneau cover fully zippered (removable), velcroed with 6 x pull down straps to minimise flapping and dust ingestion. All made out of quality rip stop PVC
- **NEW DESIGN Bowkit for easy set up and pack up.**
- All quality pegs, poles and ropes needed for setting up

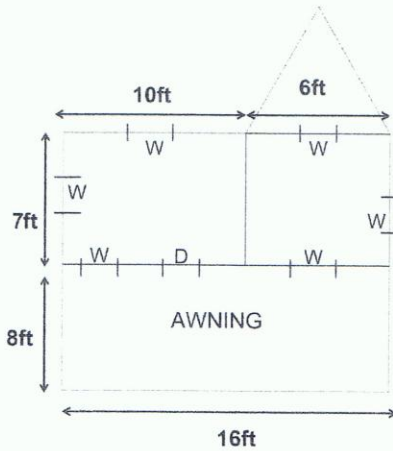

### Legend

D - Door W - Window

